

Calculation Summary							
Label	CalcType	Units	Avg	Max	Min	Avg/Min	Max/Min
PL-EAST	Illuminance	Fc	0.32	1.3	0.0	N.A.	N.A.
PL-SOUTH	Illuminance	Fc	0.00	0.0	0.0	N.A.	N.A.
PL-WEST	Illuminance	Fc	0.78	1.7	0.0	N.A.	N.A.
TRUCK PARKING_Planar	Illuminance	Fc	2.50	4.6	1.0	2.50	4.60

Luminaire Schedule									
Symbol	Label	[MANUFAC]	Description	Qty	Arrangement	Total Lamp Lumens	LLF	Lum. Watts	Total Watts
	FPL-1	①	ARCH-N-PA1-40-730-U-T3-42W	1	Single	N.A.	0.900	42	42
	P4S	LSI LIGHTING	VALM-42L-4F-30K8-IS	2	Single	N.A.	0.900	261	522

SOUTH ANDREWS AVENUE
S.W. 12th AVENUE

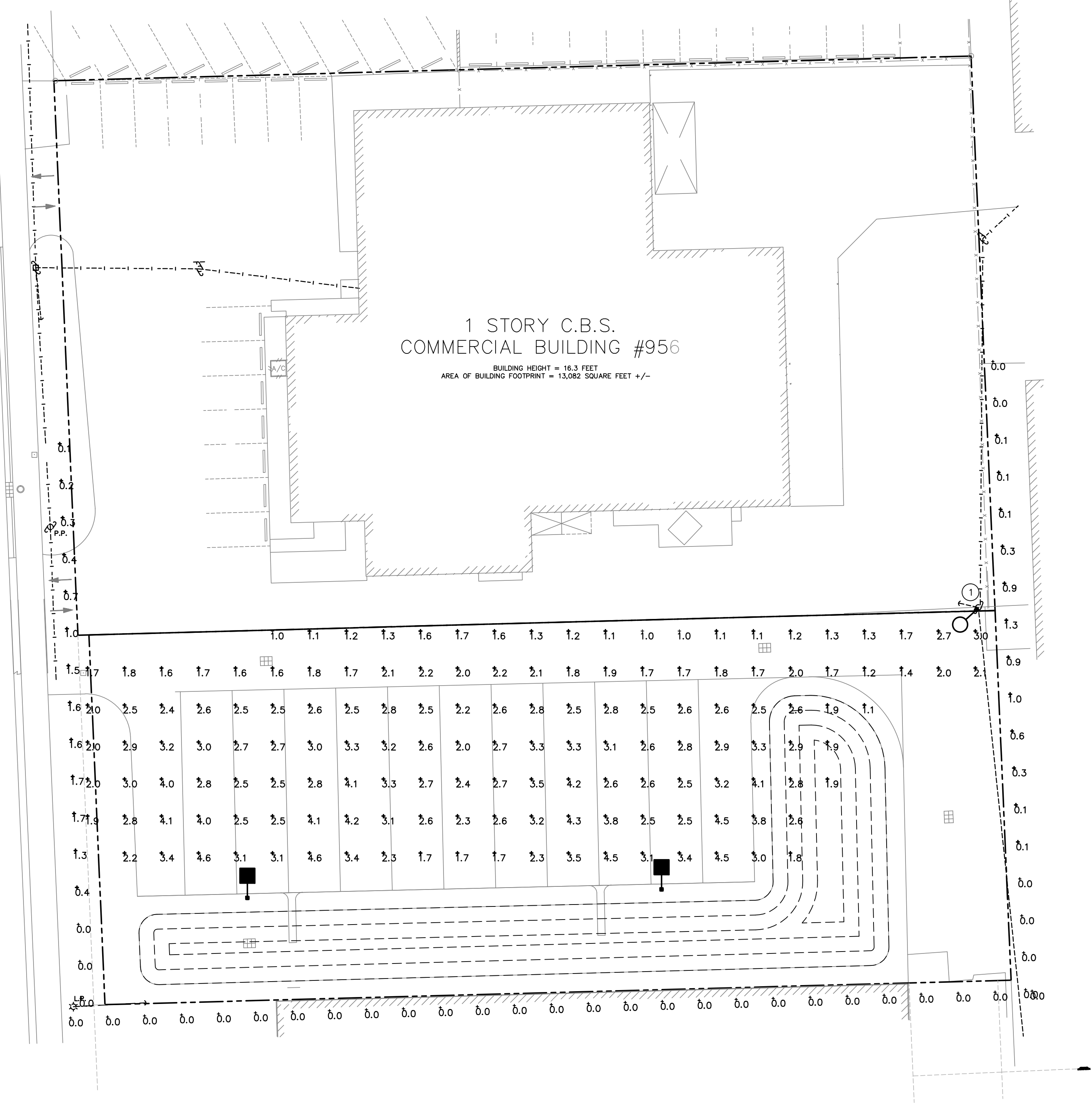

KEY NOTES

- ① LED STREET LIGHT LEASED FROM FPL MOUNTED ON POWER POLE AT 15' AFG.

SITE PHOTOMETRIC PLAN

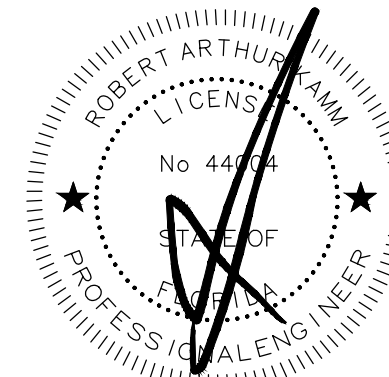

Digitally signed by Robert A Kamm
DN: cn=Robert A Kamm,
o=KAMM CONSULTING INC, c=US
Date: 2025.04.01 08:41:38-0400'

PERMIT ISSUED
CONSTRUCTION ISSUED

DRC

date	
revision	

1407 West Newport Center Drive
Pompano Beach, FL 33062
Phone 954.949.2200 Fax 954.949.2201
Engineering & Construction Consulting
KAMM CONSULTING INC. License No. 18189
4-1-2005
date
signed

Joefran Investments
980 SW 12TH AVENUE
POMPAHO, FLORIDA

SITE PHOTOMETRIC PLAN

project title:

proj. no.: 2025-0094

project manager: GK

checked by: RAK

scale: AS NOTED

date: 03/24/2025

sheet

E1.1

project

PZ25-12000010

06/04/2025